

GLENRIDDING LANDING

16204 21 AV SW, Edmonton, Alberta

FOR SALE / LEASE

*High
Exposure*



PROPERTY HIGHLIGHTS:

Welcome to GLENRIDDING LANDING (SW), CB1 Zoning, COMING APRIL 2021! BRAND NEW Prime Retail Units for SALE or LEASE. Purchase Rates Starting at \$400 PSF and Lease Rates starting at \$29 PSF (Base Rent Plus Opp Costs of \$12 PSF (Est)). LAST 2 SECOND FLOOR Units Available in this 35,931 SQFT 2 Storey. Come Join 7-ELEVEN W/Gas Bar, Pizza, Salon, Dentist, Liquor, Ethnic Restaurant, Martial Arts Studio & more. Located in the Heart of Glenridding Heights SW, with FANTASTIC EXPOSURE directly fronting Rabbit Hill Road, just South of Ellerslie Road. Quick Access to 170 Street & Anthony Henday Drive. EXCELLENT SIGNAGE Opportunities, Ample Parking, FANTASTIC GROWTH! Come Join Our Community.



MLS®:E4193732

16204 21 AV SW, Edmonton, Alberta

MaxWell
Polaris
COMMERCIAL

Maxwell Polaris-Commercial
4107 99 Street
Edmonton, AB T6E 3N4
Office: 780-450-6300

ROMI SARNA
& Associates

780-450-6300
romi@romisarna.ca
www.romisarna.ca

GLENRIDDING LANDING

16204 21 AV SW, Edmonton, Alberta

FOR SALE / LEASE

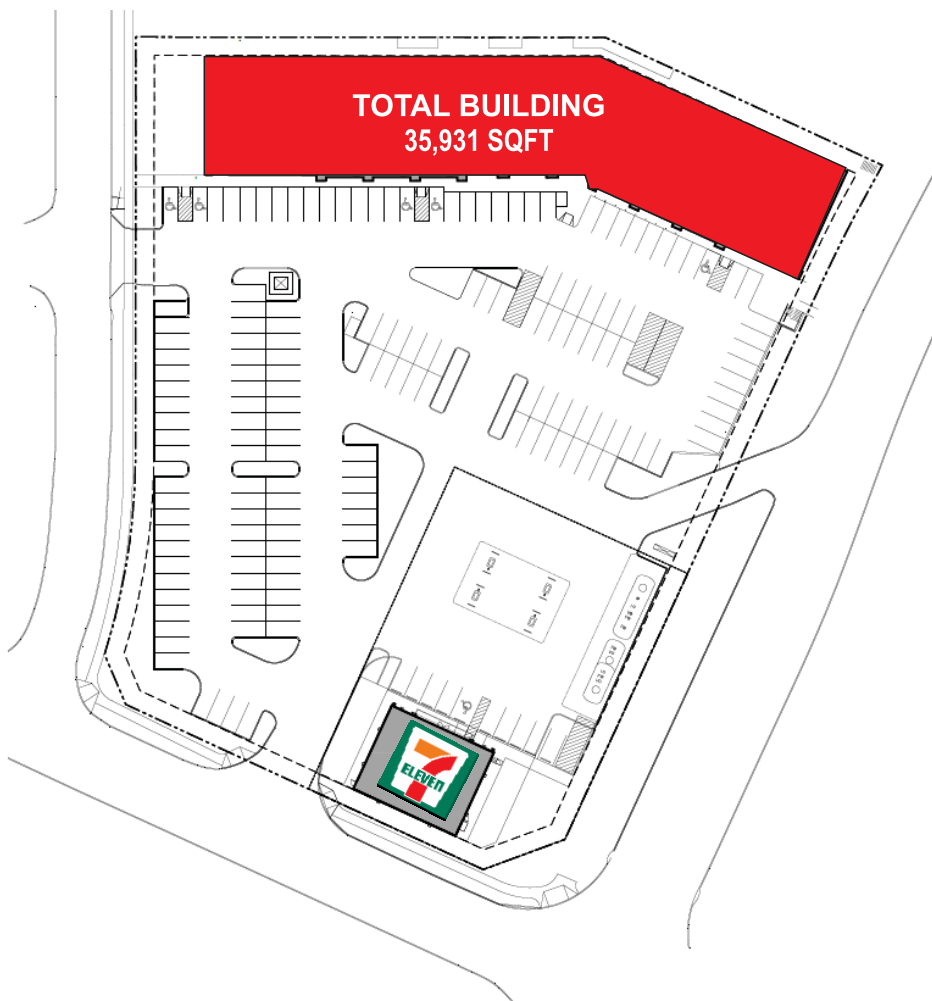

Property Type
Transaction Type : For Sale / Lease

Community : Glenridding Heights

Land Use/Zoning : CB1 Low Intensity Business Zone

Year Built : 2020

Sale Price Starting @ \$500.00 Per SqFt.
Main Floor

Sale Price Starting @ \$400.00 Per SqFt.
Second Floor

Net Lease Rate : Starting @ \$29.00
SF/Annum
Subject Space

Operating Costs (Purchase):
\$4.50/sq.ft/annum (2020 estimate)
Includes Common area,
maintenance insurance and
management fees

Operating Costs (Lease):
\$12.00/sq.ft/annum (2019 estimate)
includes taxes, common area,
maintenance insurance and
management fees



Maxwell Polaris-Commercial
4107 99 Street
Edmonton, AB T6E 3N4
Office: 780-450-6300

ROMI SARNA
& Associates
780-450-6300
romi@romisarna.ca
www.romisarna.ca

GLENRIDDING LANDING

16204 21 AV SW, Edmonton, Alberta

FOR SALE / LEASE



Main Floor

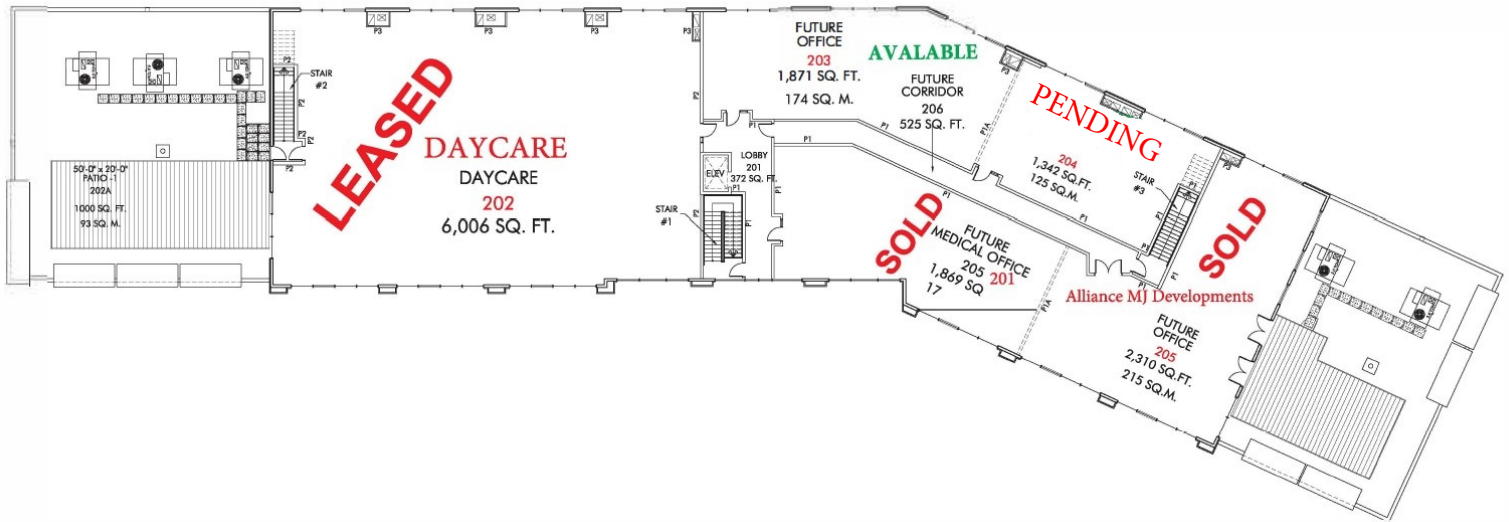

Second Floor



Maxwell Polaris-Commercial
4107 99 Street
Edmonton, AB T6E 3N4
Office: 780-450-6300

ROMI SARNA
& Associates

780-450-6300
romi@romisarna.ca
www.romisarna.ca

GLENRIDDING LANDING

16204 21 AV SW, Edmonton, Alberta

FOR SALE / LEASE

Household income

The combined gross income of all the members of a household who are 15 years old and older. Individuals do not have to be related to be considered members of the same household.

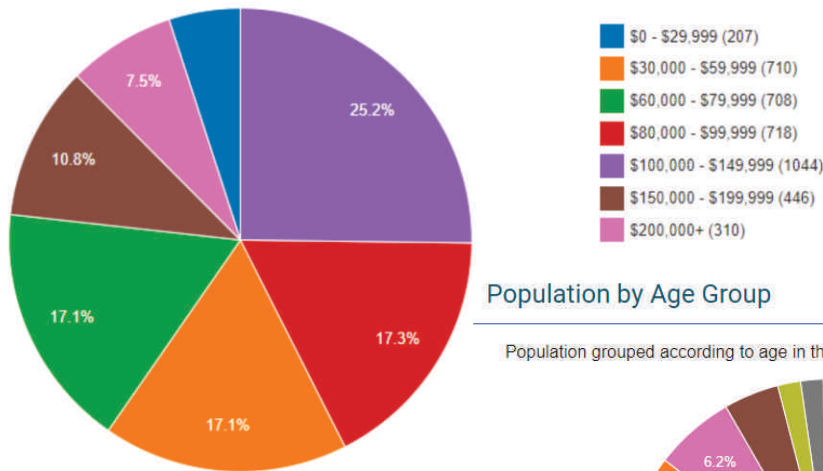

Population by Age Group

Population grouped according to age in the area containing the listing.

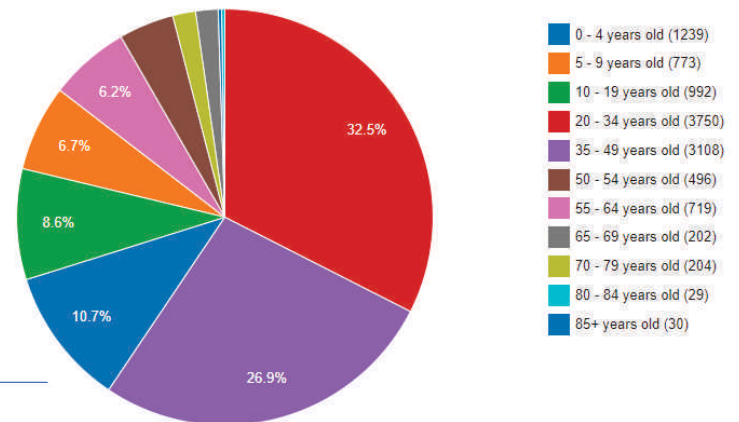

Languages

Self-identified first language or combination of languages spoken in the area.

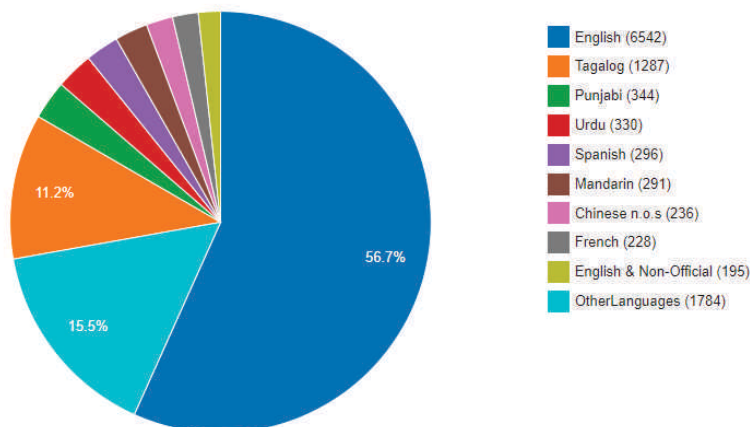

Polaris
COMMERCIAL

Maxwell Polaris-Commercial
4107 99 Street
Edmonton, AB T6E 3N4
Office: 780-450-6300

ROMI SARNA
& Associates

780-450-6300
romi@romisarna.ca
www.romisarna.ca